



13.81 ACRE 661 B FM 2550
HUNTSVILLE, TEXAS
13.81 +/- ACRES | LAKE



13.81 +/- ACRE 661 B FM 2550



Lush and green, and west of I-45! This is a fantastic tract of land, being 13.81 acres, loaded with clusters of hardwood trees. This would make for a beautiful country home getaway. Towards back of the property is a pretty lake, at just under an acre. Plenty of homesite possibilities here, so come and see some of Walker county's finest land. All of this and you're only a 15 minute drive back to Huntsville.



Markham Realty
Selling Quality Texas Properties Since 1970
contact@markhamrealty.com
936-295-5989 | markhamrealty.com



Scan here for additional information & photos.



Information furnished is from sources deemed reliable, but is not guaranteed by Markham Realty, Inc. The offerings are subject to change in price, errors, omissions, prior sales, or withdrawal without notice. Square footage, acreage size and lot dimensions are approximate. All persons and firms named in this brochure are licensed brokers or salespersons. Markham Realty, Inc. will co-broker with any licensed Broker if Broker and/or agent accompanies his or her prospective buyer from the first (1st) showing forward.

13.81 +/- ACRE 661 B FM 2550

HUNTSVILLE, TEXAS

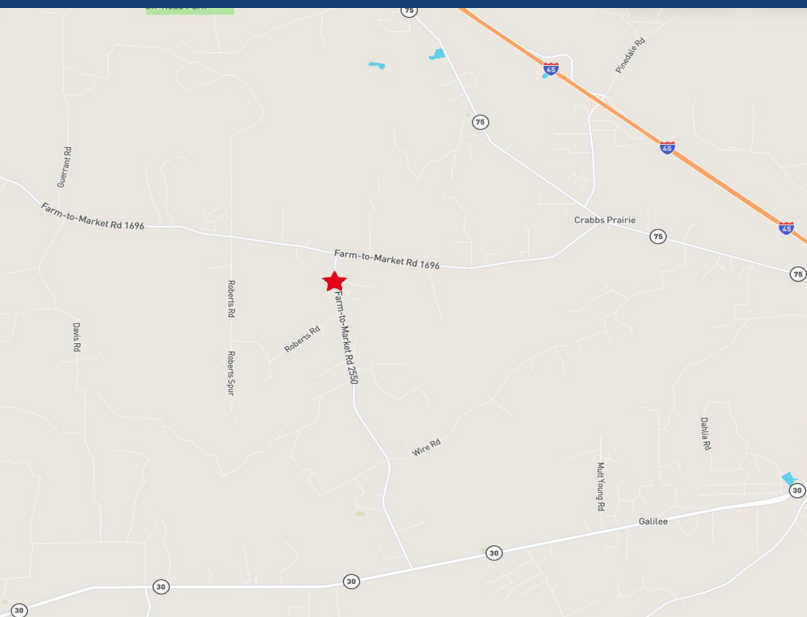

From Huntsville, follow Hwy 30 west for approximately 7 miles to FM 2550 and turn right. Follow about 4.3 miles to the property on the left.

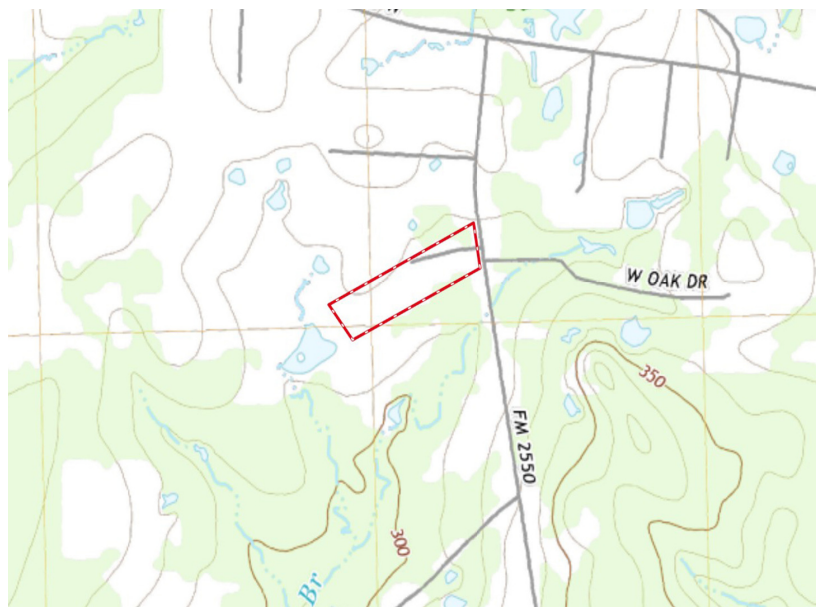

Markham Realty
Selling Quality Texas Properties Since 1970
contact@markhamrealty.com
936-295-5989 | markhamrealty.com



Scan here for additional information & photos.



Information furnished is from sources deemed reliable, but is not guaranteed by Markham Realty, Inc. The offerings are subject to change in price, errors, omissions, prior sales, or withdrawal without notice. Square footage, acreage size and lot dimensions are approximate. All persons and firms named in this brochure are licensed brokers or salespersons. Markham Realty, Inc. will co-broker with any licensed Broker if Broker and/or agent accompanies his or her prospective buyer from the first (1st) showing forward.